

## DATACOM ADAPTERS

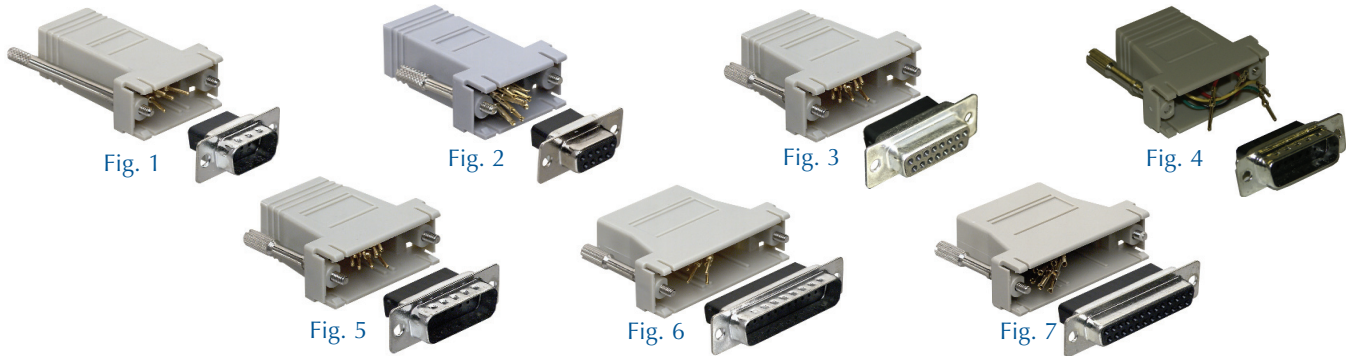

### Telco Adapters

Retail Part No.	Bulk Part No.	Fig. No.	Description
45-5108	45-5108-BU	1	4C (RJ11)/DB9 Male
45-5109	45-5109-BU	1	6C (RJ12)/DB9 Male
45-5110	45-5110-BU	1	8C (RJ45)/DB9 Male
45-5111	45-5111-BU	2	4C (RJ11)/DB9 Female
45-5112	45-5112-BU	2	6C (RJ12)/DB9 Female
45-5113	45-5113-BU	2	8C (RJ45)/DB9 Female
45-5117	45-5117-BU	3	8C (RJ45)/DB15 Female
45-5118	45-5118-BU	4	4C (RJ11)/DB15 Male
45-5120	45-5120-BU	5	8C (RJ45)/DB15 Male

### Telco Adapters (Cont.)

Retail Part No.	Bulk Part No.	Fig. No.	Description
45-5121	45-5121-BU	6	4C (RJ11)/DB25 Male
45-5122	45-5122-BU	6	6C (RJ12)/DB25 Male
45-5123	45-5123-BU	6	8C (RJ45)/DB25 Male
45-5124	45-5124-BU	6	10C (RJ45)/DB25 Male
45-5125	45-5125-BU	7	4C (RJ11)/DB25 Female
45-5126	45-5126-BU	7	6C (RJ12)/DB25 Female
45-5127	45-5127-BU	7	8C (RJ45)/DB25 Female
45-5128	45-5128-BU	7	10C (RJ45)/DB25 Female

### Modular Pin Wire Color Code (for 45-5108 to 45-5128)

Wire	Purple	Blue	Orange	Black	Red	Green	Yellow	Brown	Gray	White
10C-RJ45	1	2	3	4	5	6	7	8	9	10
8C-RJ45		1	2	3	4	5	6	7	8	
6C-RJ12		6		2	3	4	5			1
4C-RJ11				1	2	3	4			

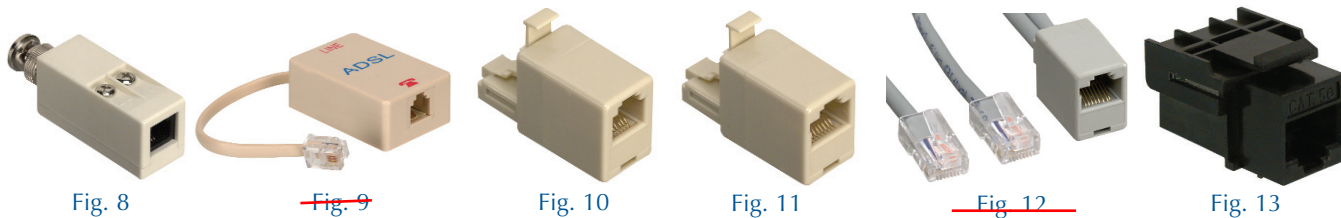
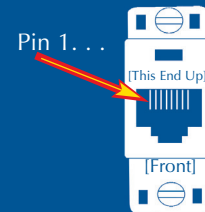

### Telco Balun

Retail Part No.	Bulk Part No.	Figure No.	Description
45-5407	45-5407-BU	8	Adapter BNC Male/4C (RJ11) Female

### ~~ADSL Filters~~

Retail Part No.	Bulk Part No.	Figure No.	Description
<del>45-1625</del>	<del>45-1625-BU</del>	<del>9</del>	<del>Adapts DSL Equipped Homes to Standard Modular Phone Systems</del>

### Adapters

Retail Part No.	Bulk Part No.	Figure No.	Description
45-4506		10	USOC (Telephone) RJ12 Female/8P6C (RJ45) Male Cat 5
45-4545		10	USOC (Telephone) RJ45 Male/8C (RJ45) Female Cat 5
45-6645		11	USOC 6C RJ12 Male/8P6C (RJ45) Female USOC
<del>45-5787</del>	<del>45-5787-BU</del>	<del>12</del>	<del>Cat 5 8C RJ45 1 Female/2 8C RJ45 Male</del>

### Inline Couplers

Retail Part No.	Bulk Part No.	Figure No.	Description
45-5439	45-5439-BU	13	Cat 5e Coupler, 8C (RJ45) Female/Female